



One-stop supplier  
Delivery reliability  
Customer support

Quality focus  
Share global supply chain risk  
IP protection



# Amat Sinar Lighting Decorative Luminaires

Your best partner of lighting solutions in Malaysia

## AMAT SINAR LIGHTING CO.,LTD

Headquarter: No 23-1, 1st Floor, Jalan 3/27D, Seksyen 6 Wangsa Maju, 53300 Kuala Lumpur, Malaysia  
Sales Office: Room 1219, Xinmao Building, No.99 Tianzhou Road, Xuhui District, 200233 Shanghai, China

[www.amatsinar.com](http://www.amatsinar.com)





# About ASL



A.S. Lighting stands as a joint venture between two manufacturers in China and Malaysia - Hosca Lighting Co., Ltd and Amat Sinar Sdn Bhd. Originally established as a reputable trading company, our unwavering commitment to quality has garnered extensive support and recognition from renowned outdoor lighting product manufacturers in China, Malaysia and over 40 of our collaborative partners around the world. Our aim to cement our name as trusted and esteemed supplier and vendor, offering cutting-edge street lights, area lights, flood lights, and lighting poles renowned for their patented designs and quality.



ISO9001:2015



EN40-5



Lumileds Partner



Osram Partner



Ministry of  
Finance Award



SME Corp  
Enterprise 50 Award



Quality  
Management Excellent



TNB Best Partner

At A.S. Lighting, quality reigns supreme above all other considerations, as such, equipped with team of highly skilled engineers and quality professionals and the know-how and knowledge of the two countries as well numerous support both locally and globally.

Remaining at the forefront of technological advancements, A.S. Lighting boldly ventures into innovative domains, integrating IoT equipment and solar solutions into our product portfolio. Our relentless pursuit of excellence has been recognized through prestigious certifications, including the esteemed ISO 9001, as well as accolades such as the Malaysia SME Enterprise 50, earned through our continuous achievements. In addition to our extensive range of outdoor lighting products, we provide superior spare parts catering to diverse industries such as electrical, telecommunications, automotive, and oil and gas, serving the needs of both government and private sectors. With utmost sincerity, we extend a warm invitation to those who share our vision of cultivating better cities. Join us on this collective journey, dedicated to creating urban environments that are safer, more sustainable, and truly illuminated. Together, let us transform cities into beacons of light and progress.

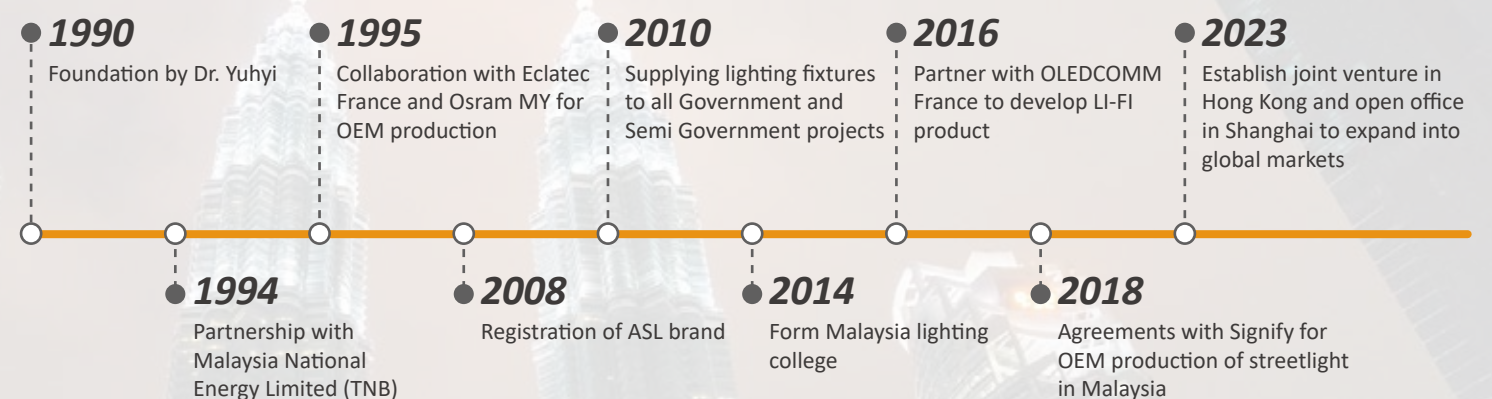



# Achievements

- 01
- Achieved ISO 9001 : 2008 And QAS certification
- 02
- IESNA sustaining member (Illumination Engineering Society of North America)
- 03
- MIESO member (Malaysia Illumination Engineering Society)
- 04
- MIESMA member (Malay Illumination Engineering Society of Malaysia)
- 05
- Appointed as lighting consultant company by Ministry of Finance (MOF)
- 06
- Committee Advisor for Standards and Industrial Research Institute of Malaysia (SIRIM)
- 07
- Develop Pilot project for Geographical Information System (GIS) Application and Hardware for Public Works Department (JKR)
- 08
- Appointed as vendor by Public Works Department (JKR)

## Wild application



From the ambient glow of indoor décor lighting to the architectural accentuation of outdoor façade lighting, our brass and copper luminaires have illuminated spaces ranging from the grandeur of luxury hotel halls to the warmth of residential homes. They have adorned settings as diverse as Chinese temples and Muslim mosques, earning acclaim in both the domestic and international markets.



# Our factory

## Copper workshop



## Metal Forming Process

Our skilled and experienced craftsmen employ a variety of mold tooling and compressive forming processes, including rolling, extrusion, stamping, bending, die forming, spinning, and more. They leverage their expertise and craftsmanship to achieve the precise design of each luminaire as specified by our customers.

We operate two brass tooling workshops and three metal forming workshops, as well as one machining workshop and one cladding workshop in Kuala Lumpur. Additionally, our in-house capabilities include one casting workshop, one forging workshop, and two machining workshops.

”

## Testing Center



## Assembly line







# Landscape Lights

## Spot Up Light

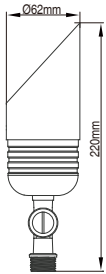

ASLS01

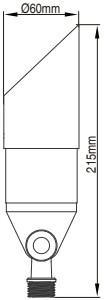

ASLS02

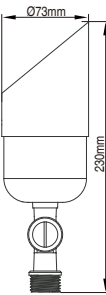

ASLS03

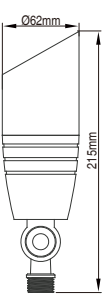

ASLS04

## Wall Sconce

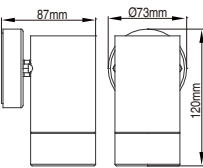

ASLW01

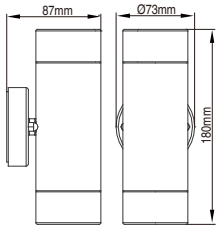

ASLW02

Material Options	Hot Stamping Copper / Brass	CRI	>80
Finish	Antique Brass / Machined Brass / Brushed Brass / Polished Brass	CCT	2700-6500K
Light Source	8W MR16 GU5.3 LED bulb / 12W LED Module	Voltage	AC/DC 12V/24V, 60Hz
Lumens	600lm (MR16) /1200lm (LED module )	Rating	IP54 (can be updated to IP65)
Option	Tunable White/RGBW/Bluetooth control (via transformer)		



# Waterproof Lights

## Underwater Light



ASWU01

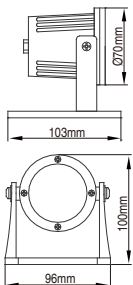

ASWU02

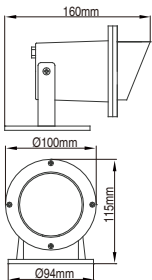

ASWU03

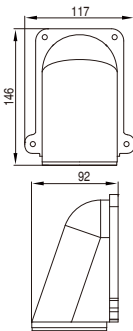

ASWU04

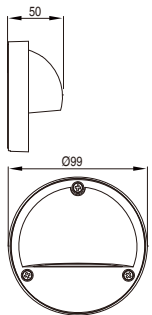

## Vandal Resistant



ASWV01

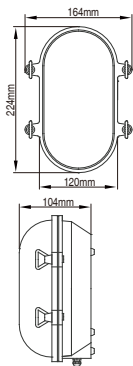

ASWV02

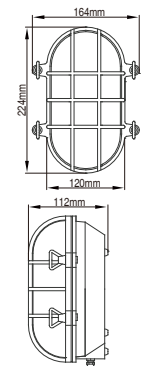

ASWV03

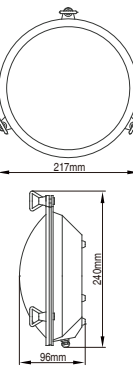

ASWV04

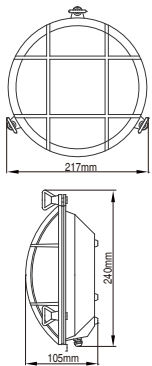

Material Options	Hot Stamping Copper / Brass	CRI	>80
Finish	Antique Brass / Machined Brass / Brushed Brass / Polished Brass	CCT	2700-6500K
Light Source	8W MR16 GU5.3 LED bulb / 12W LED Module	Voltage	AC/DC 12V/24V, 60Hz
Lumens	600lm (MR16) /1200lm (LED module )	Rating	IP54 (can be updated to IP65)
Option	Tunable White/RGBW/Bluetooth control (via transformer)		

# Path Lights



Material Options	Hot Stamping Copper / Brass	CRI	>80
Finish	Antique Brass / Machined Brass / Brushed Brass / Polished Brass	CCT	2700-6500K
Light Source	4.2W G4 LED bulb / 6W LED Module	Voltage	AC/DC 12V/24V, 60Hz
Lumens	470lm (COB G4) /800lm (LED module)	Rating	IP54 (can be updated to IP65)
Option	Tunable White/RGBW/Bluetooth control (via transformer)	Mount	Spike or Prone Stake

Material Options	Hot Stamping Copper / Brass	CRI	>80
Finish	Antique Brass / Machined Brass / Brushed Brass / Polished Brass	CCT	2700-6500K
Light Source	4.2W G4 LED bulb / 6W LED Module	Voltage	AC/DC 12V/24V, 60Hz
Lumens	470lm (COB G4) /800lm (LED module)	Rating	IP54 (can be updated to IP65)
Option	Tunable White/RGBW/Bluetooth control (via transformer)	Mount	Spike or Prone Stake



# Die-cast Brass Luminaires



ASD01

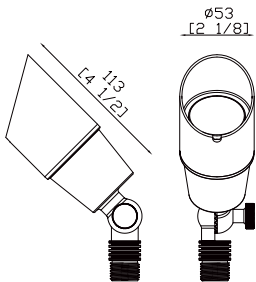

ASD02

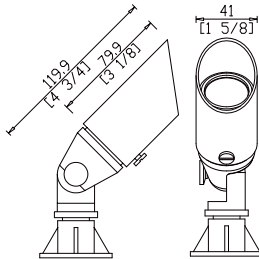

ASD03

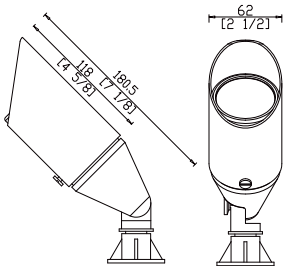

ASD04

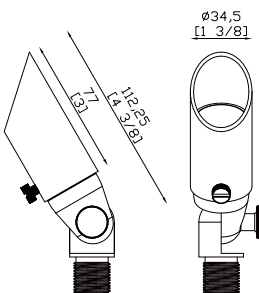

ASD05



ASD06



ASD07



Material Options	Die casting Brass	CRI	>80
Finish	Antique Bronze	CCT	2700-6500K
Light Source	MR16 / G4 / LED PCB Module	Voltage	AC/DC 12V/24V, 60Hz
Wattage	Up to 50W	Rating	IP65
Option	Tunable White/RGBW/Wifi control (via transformer)		

# Fixture Accessories



## Actual Photos

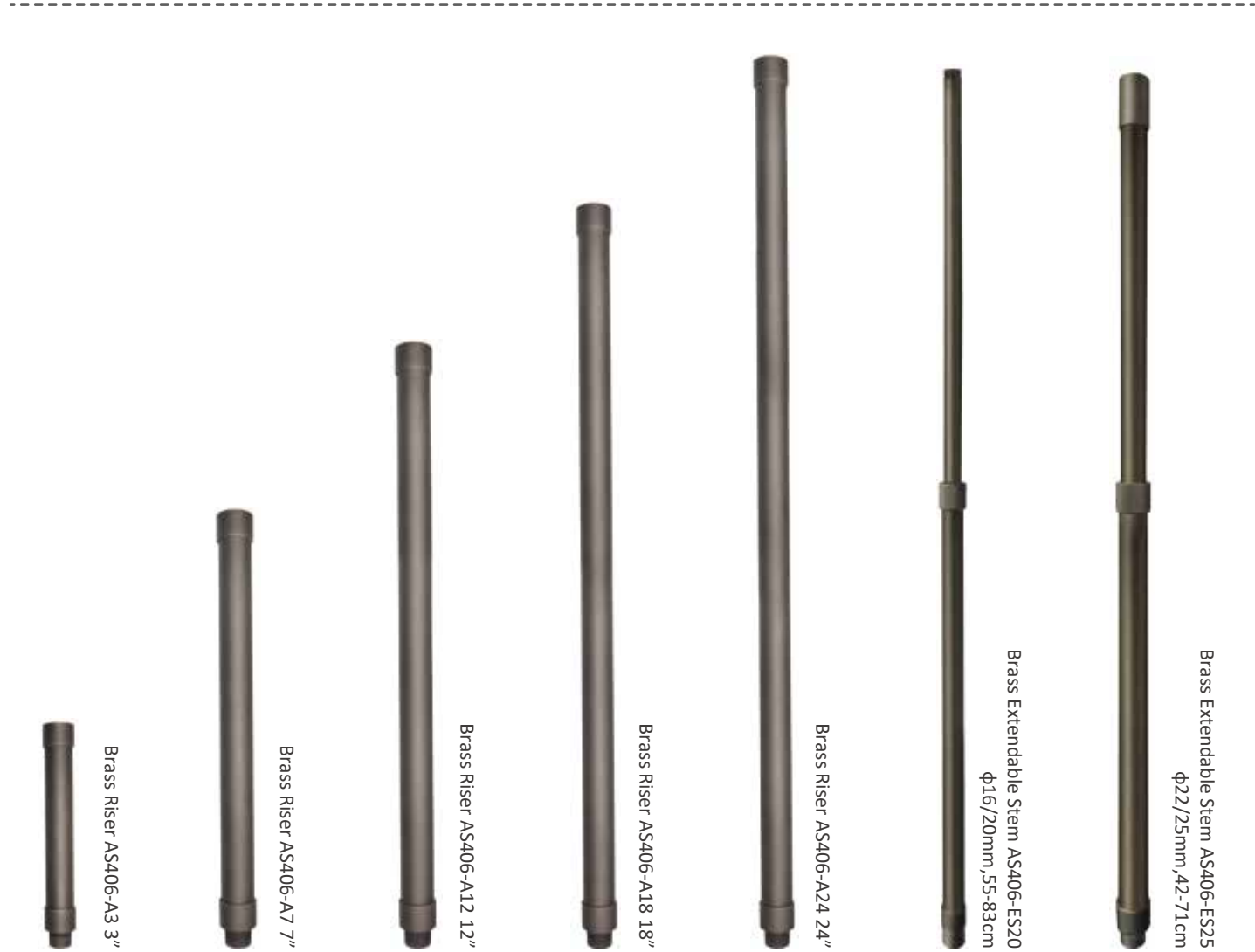



# New Technical Innovation

“ New technologies assists to upgrade the traditional luminaire

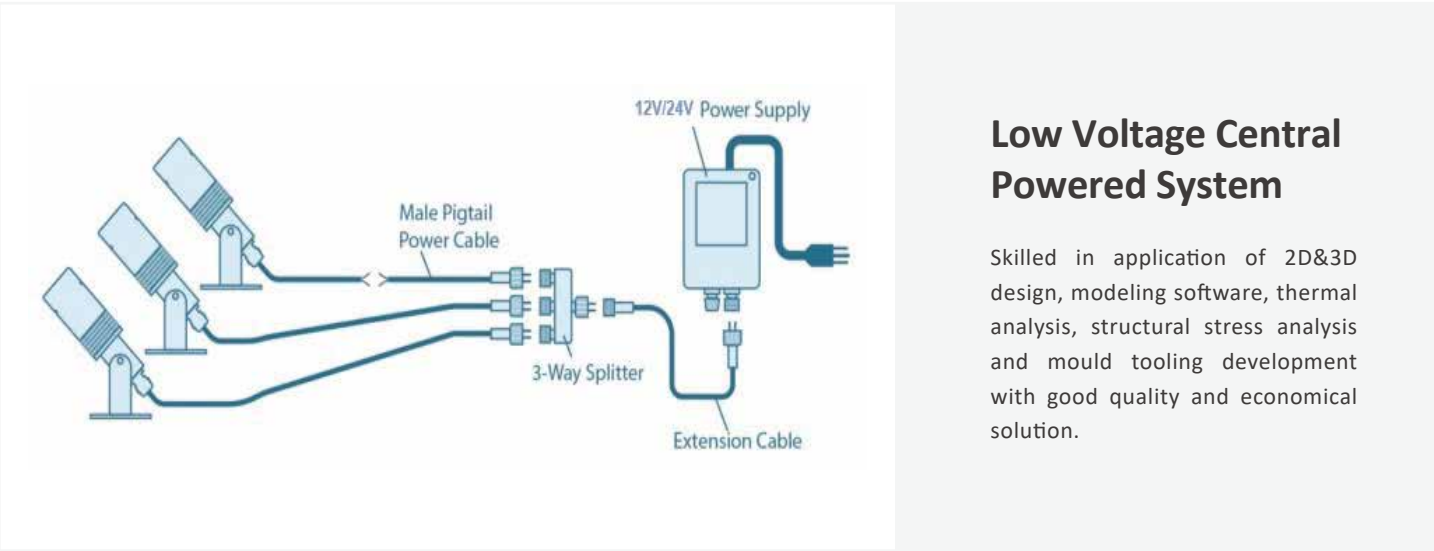

**RGB Tuning and Tunable White**

Ability to design LED PCBs, Drivers, SPD and master the technology of DALI, D4i, NB-IoT, LoRa and PLC. We combine the luminaire with different IoT and Sensor solutions to meet different application requirement.



**Smart Connection Integrated**

Lead by Dr. Yusha'a in PhD Optic Science, Amat Sinar has a professional optical design team for lighting fixtures. Designers skillfully apply software such as Dialux and Relux to simulate different lighting application.

# Low Voltage Landscape System



Outdoor Low Voltage Landscape Lighting Transformer in Stainless Steel case with Transparent plastic cover with Wifi / Bluetooth connection, 120V AC Input to 12V AC Output



Outdoor Low Voltage Landscape Lighting,Transformer with Timer and Sensor, 120V AC Input to 12V AC Output



Toolless and Waterproof Fast connectors



Outdoor Linear Transformer with ON/OFF/AUTO photosensor/Timer 1-9hr setting,120V AC Input to 12V AC



**Typical Landscape System**  
1x60W Low voltage transformer with Wifi connection,6x8w RGBW LED Copper spotlights, 1x extension cable(18AWG 50FT) with 6pcs quick cable connector.



Extension cable  
14/16/18AGW/meter  
underground sun-resistant



# Metal Painting

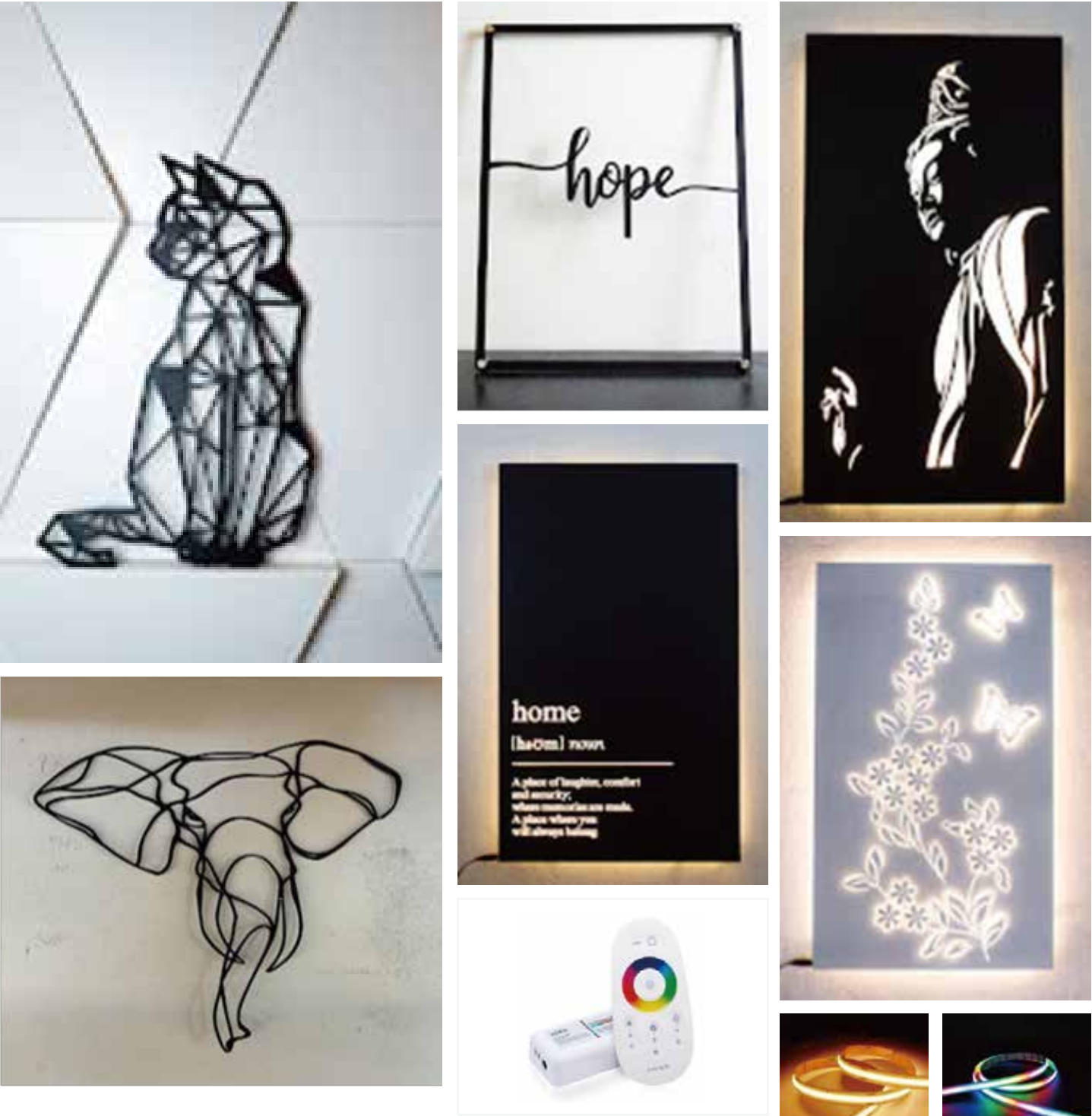

Material Options	Extruded Aluminum/Bened Brass	CRI	80
Finish	White/Black/Chrome/Polished Brass/Brushed Brass/Antique Brass	CCT	2700-6500K
Light Source	SMD 3030 LED strip / COB Dot-free strip	Rated powe	24W/M ( SMD ), 10W/W (COB)
Lumens	2640-2880 lm/M (SMD) , 600-2300lm/M (COB)	Voltage	Input AC 220-240V,Output DC 12-24V
Option	Tunable White/RGBW/Blueetooth control (via remote controller)	Rating	IP67

# New Light Source



Power Consumption	8W	CRI	>80
Lumens Output	600lm	CCT	2700-6500K
Efficacy	75 LPW	Lifespan	25,000 hrs
Beam Angle	25 degrees		



Power Consumption	4.2W	CRI	>80
Lumens Output	470lm	CCT	2700-6500K
Efficacy	110 LPW	Lifespan	20,000 hrs
Beam Angle	360 degrees		



Power Consumption	4.2W	CRI	>80
Lumens Output	470lm	CCT	2700-6500K
Efficacy	100 LPW	Lifespan	50,000 hrs
Beam Angle	15, 24 , 55 degrees		



# New Smart Modules

## Dimming Version

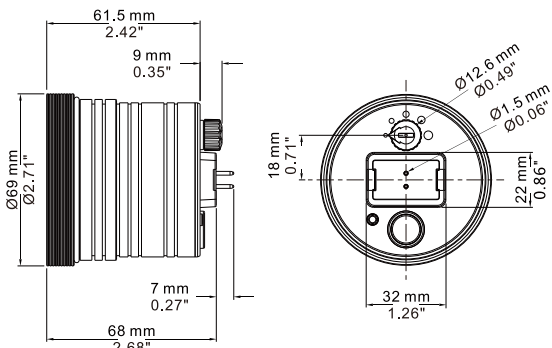

ASLM40A

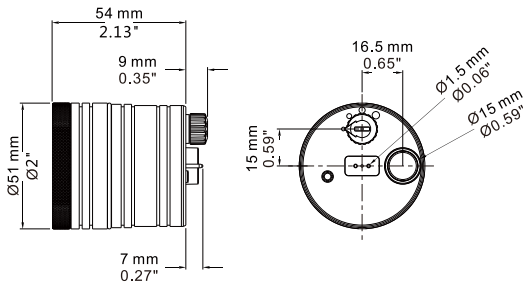

ASLM40B

Input Voltage	12V AC/DC	CRI	>80
Power	2W/4W/6W/9W/12W	CCT	2700-6500K
Lumens Output	200/400/600/900/1200lm	Efficacy	100 LPW
Beam Angle	15/24/40/60 degrees	Lifespan	50,000 hrs

Input Voltage	12V AC/DC	CRI	>80
Power	2W/4W/6W/9W	CCT	2700/3000K
Lumens Output	160/350/520/700/1200lm	Efficacy	80 LPW
Beam Angle	15/24/40/60 degrees	Lifespan	50,000 hrs

## BLE version

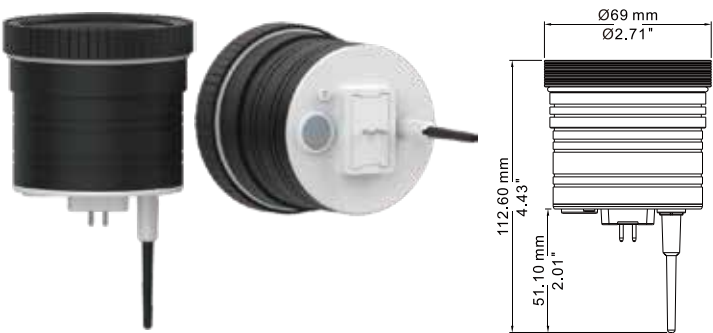

ASLM40A1(RGBCW)

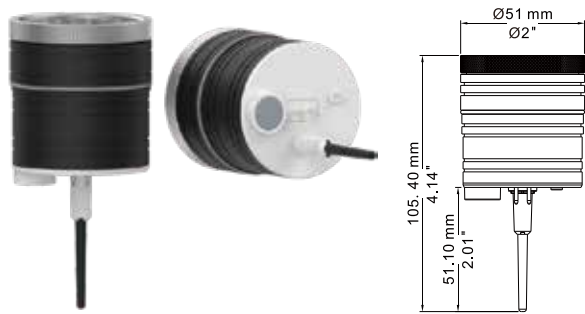

ASLM40B1(RGBCW)

Input Voltage	12V AC/DC	CRI	>80
Power	10W	CCT	RGB+2200-6000K
Lumens Output	2350lm@4200K	Efficacy	100 LPW
Beam Angle	40W degrees	Lifespan	50,000 hrs

Input Voltage	12V AC/DC	CRI	>80
Power	7W	CCT	RGBW mixed
Lumens Output	350lm@4000K mixed	Efficacy	100 LPW
Beam Angle	40W degrees	Lifespan	50,000 hrs

## Smart control



Download APP  
Android Search Btooth1  
IOS Search Btooth1



## Replaceable module design

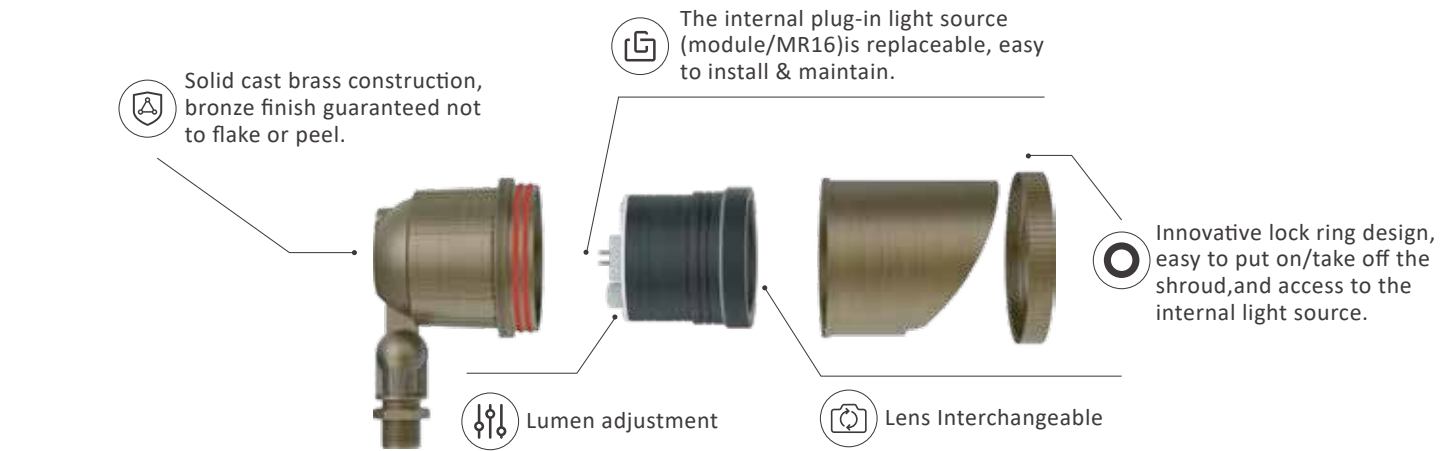
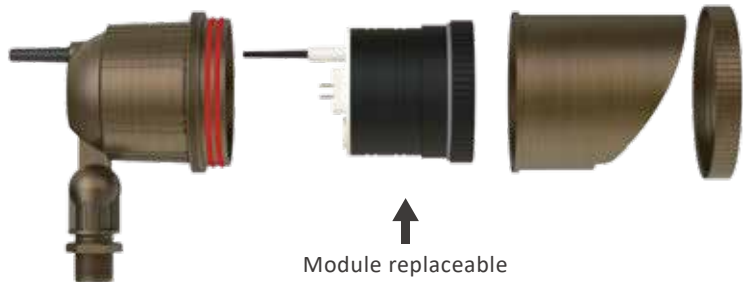



# Our Benefits

Raw material price	SHFE price only	SHFE and LME price
Copper raw material price	SHFE price only	SHFE and LME price
Metal Craftsmanship	Extensive years of experience and practice	Extensive years of experience and practice
Intellectual Propriety Protection	Limited by local law, not subject to international arbitration, high regional competition	Adheres to international laws with the capability for international arbitration, low competition nationally
Technical Innovation	Predominantly traditional light sources, constraints on advanced smart connection technologies, concerns with cybersecurity	Exclusively LED modular engines, partnerships with global brands for cutting-edge smart technologies, robust cloud service security
US Custom duties	Additional 25% tax on Chinese imports	No additional import duties
Delivery time to US	38-45 days to West Coast, 45-60 days to East Coast	25-34 days to West Coast,38-45 to East Coast
Communication	Often requires Chinese translation for factory communication	English as the official secondary language, fluent at the operator level
Customer Service	Purely FOB business model, with no after-sales service provided in the USA	Presence of a local US agent capable of handling customer claims, maintaining local inventory, and managing logistics

